

A.C. FREQUENCY POWERLESS EDGEWISE BARGRAPH METER

MODEL
572

U.S. Patent No.
4,908,569

Features

- Replaces Vane Meters
- Signal Powered
- High Reliability
- 101 Segments
- Vertical or Horizontal Mount
- Hi & Low Annunciators
- Over & Under-range Annunciators
- NEMA 3 Standard
- NEMA 4 (on request)
- Optional Backlight
- Less than 1" Deep

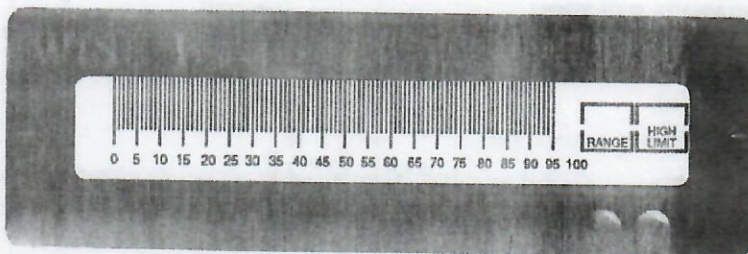

HORIZONTAL

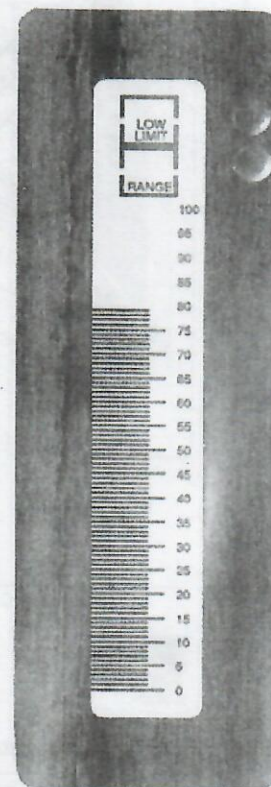

VERTICAL

TRUE RMS AC

DESCRIPTION: Model 572 works off the principle of frequency to voltage conversion and its reading is independent (within range) of A.C. Voltage variations. However, it is sensitive to other than sine wave inputs with more than 12% distortion and since it triggers on the "zero crossing". **Signals with "spikes" should be avoided.**

ANNUNCIATORS: Hi & lo adjustable included, in addition to over & under-range. The "Hi Limit" annunciator will turn on when its setting is exceeded. The same holds true for "Low Limit" annunciator except that it will illuminate when the signal is less than its setting. The "Out of Range" annunciator will turn on whenever the signal is greater than F.S. (100%) or less than zero (negative).

CONNECTORS: A flat ribbon 26 pin connector is standard and it's included with the meter. An optional screw terminal connector is available, (see ordering information).

BACKLIGHT: Standard display is reflective black segments over silver background. An optional backlight is available at time of ordering. When ordered, the segments are black over an illuminated background. **Screw terminal connector must be ordered.** The intensity is not adjustable, and it's powered by the signal (line), (see Typical Connections).

LIGHT SOURCE: Electroluminescent and it is powered by the signal requiring only 2mA at 120-500VAC. The E.L. has uniform light output, and its life expectancy is in excess of 15,000 hours.

SCALES: Standard marking is 0-100%. A custom overlay can be made to your specifications for the bargraph. Contact Otek.

SPECIFICATIONS AT 25°C

Accuracy and Linearity	±1% of full scale
Maximum Input Signal (volts)	High range
Operating Frequency Range	50-60Hz (others on request)
Maximum Power Consumption	1 watt
Nominal Power Consumption	100mW
Measuring Method (freq.)	Freq. to voltage
Span Adjustment Range	±30% of full scale
Zero	Automatic
Backlight Operating Range (for DC-AC)	60-200V and 200-500V; 50-400Hz
Temperature Coefficient	100PPM/°C
Operating/Storage Temperature	-10° to +60°C/-20° to +70°C
MTBF	80,000 Hours
Display	101 Segment Reflective LCD

CASE MATERIAL: U.L. approved ABS Polycarbonate 94V0 rated. Black matte with acrylic antiglare treated window.
ENVIRONMENTAL: NEMA 3 standard; NEMA 4 on request; Gasket included and adjustment plugs sealed (not field scaleable).

ORDERING INFORMATION (1/1/97)

MODEL **5** **7** **2** **□** **□** **□** **□**

OPERATING VOLTAGE RANGE
01 60-200VAC
02 200-500VAC

CONNECTOR
0 Flat Ribbon
1 Screw Terminal

BACKLIGHT(1), CASE MTG.
0 No Bklt, Vertical
1 Backlight, Vertical
4 No Bklt, Horizontal
5 Backlight, Horizontal

NEMA 4 HOUSING ON REQUEST.
Contact Otek

(1) Uses the A.C. line to power the backlight and must order screw terminal connector.

572 MECHANICALS & TYPICAL CONNECTIONS

DESCRIPTION

VERTICAL

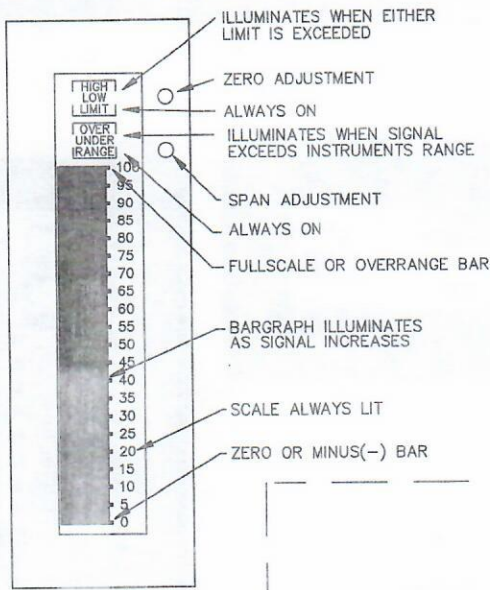

HORIZONTAL

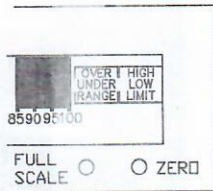

NOTE: HORIZONTAL 570 HAS THE SAME MECH. DIM. AS VERTICAL, EXCEPT THEY ARE ROTATED 90 DEGREES CLOCKWISE.

MECHANICALS

FRONT VIEW

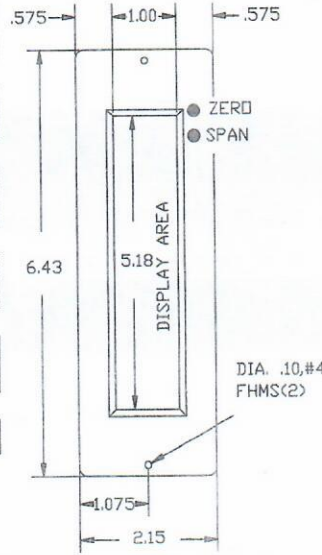

SIDE VIEW

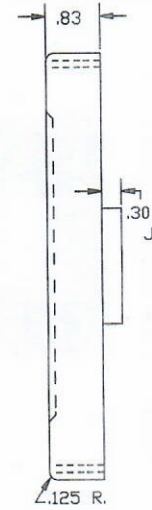

REAR VIEW

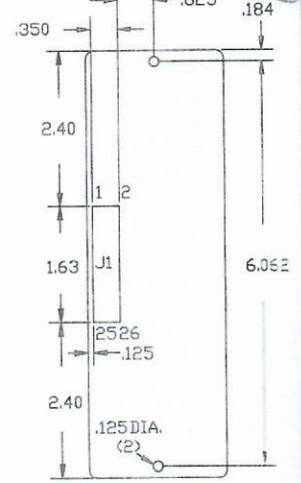

OPTIONAL SCREW TERMINAL CONNECTOR

FRONT VIEW



SIDE VIEW

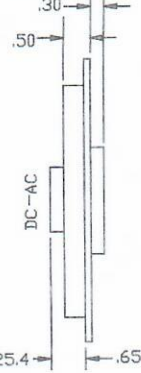

NOTE: mm = INCH X 25.4

CONNECTOR REAR VIEW

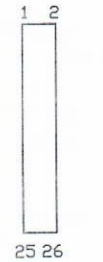

STD. 26 PIN MALE FLAT RIBBON CONN.

PANEL CUT-OUT FRONT VIEW

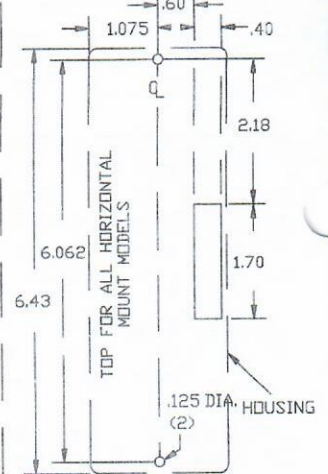

MOD. 572 AC FREQ. POWERLESS TYPICAL CONNECTIONS

WARNING: NO ISOLATION
DO NOT CONNECT TO OTHER PINS

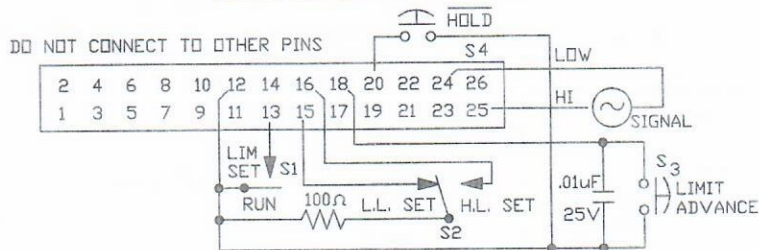

NOTES: (1) DO NOT CONNECT PINS NOT SHOWN CONNECTED. (2) S1 & S2 CAN BE COMBINED INTO ONE SWITCH HAVING CENTER OFF DPDT (ON-NONE-ON).

F#87MC572.DWG

FAX: 520-790-2808
E-MAIL: otekcorp@primenet.com
Fax-Back#: 520-748-1539--0572
520-748-7900

OTЕК™
CORP.
SINCE 1974

4016 E. TENNESSEE ST.
TUCSON, AZ. 85714 U

MADE
IN
USA

