

RTD TEMPERATURE EDGEWISE BARGRAPH METER

MODEL
575

U.S. Patent No.
4,908,569

Features

- Platinum PT100 (0.00385 Alpha)
- High Stability Current Source
- 101 Segments
- Vertical or Horizontal Mount
- Hi & Lo Annunciators
- Over & Under-range Annunciators
- NEMA 3 Standard
- NEMA 4 (on request)
- Optional Backlight
- Less Than 1" Deep

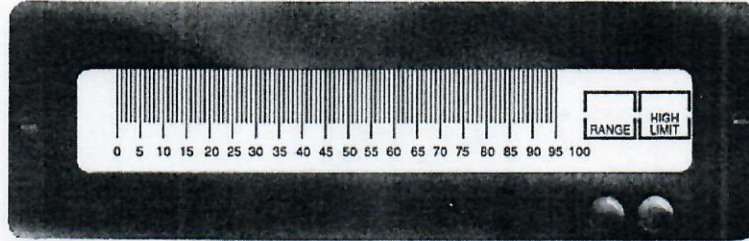

HORIZONTAL

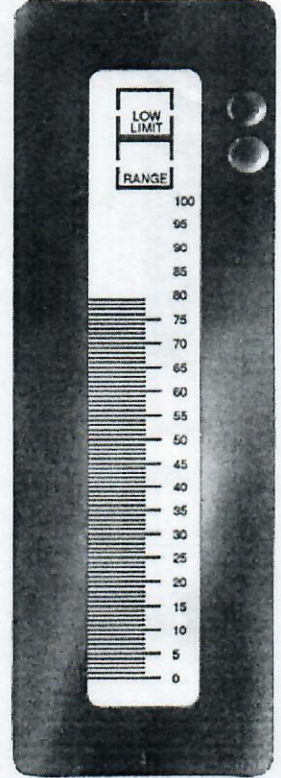

VERTICAL

TEMPERATURE RTD

DESCRIPTION: Model 575 requires 5VDC power to operate and is of the 2 or 3 wire type. Standard calibration is for PT100 having a TC of 0.00385 $\Omega/\Omega/^\circ\text{C}$ and operating range (of RTD) is typically -200°C to $+600^\circ\text{C}$. Since the 575 is unipolar, only positive temperature ranges are available. Scale calibration of $^\circ\text{F}$ or $^\circ\text{C}$ is available.

ANNUNCIATORS: Hi & lo adjustable annunciator is included, in addition to over & under-range. The "Hi Limit" annunciator will turn on when its setting is exceeded. The same holds true for "Low Limit" annunciator except that it will illuminate when the signal is less than its setting. The "Out of Range" annunciator will turn on whenever the signal is greater than F.S. (100%) or less than zero (negative).

CONNECTORS: A flat ribbon 26-pin connector is standard and it's included with the meter. An optional screw terminal connector is available, (see ordering information).

BACKLIGHT: Standard display is reflective black segments over silver background. An optional backlight is available at time of ordering. When ordered, the segments are black over an illuminated background. **Screw terminal connector must be ordered.** The intensity is not adjustable, (see Typical Connections). **Backlight is not available with 7-32VDC power option.**

LIGHT SOURCE & POWER SUPPLIES FOR BACKLIGHT OPTION: Otek uses an electroluminescent (E.L.) light source requiring 120VAC @ 400Hz to operate. The E.L. has a uniform light output, and its life expectancy is in excess of 15,000 continuous hours. Power supplies are externally mounted. Two types are available, the "Open Frame" style accepts 120/240VAC and delivers 5VDC up to 400mADC.

The "Power Pack" is a wall plug-in module, available only for 120VAC input and delivers 5VDC up to 400mADC.

COMMON MODE VOLTAGE: The unit can be connected in differential mode with up to 2VDC/AC between digital ground (pin 12) and - signal (pin 4). For better results and noise rejection connect the unit in single ended mode (digital ground to - signal), (see Typical Connections).

SCALES: Standard marking is 0-100%. A custom overlay can be made to your specifications for the bargraph, (contact Otek).

SPECIFICATIONS AT 25°C

Accuracy and Linearity	$\pm 1\%$ of F.S. ± 1 digit
Excitation Current	500 μA max
Current Source Stability	$\pm 0.01\%$ $^\circ\text{C}$ (0-40 $^\circ\text{C}$)
Open RTD Indication	Over-range
Input Type	2 or 3 wire PT100 (0.00385 alpha)
Zero Adjustment	$\pm 30\%$
Full Scale Adjustment	$\pm 30\%$ of F.S.
Range (Resolution)	1000 $^\circ/100^\circ$ (10 $^\circ/1^\circ$)
Power Requirement	5VDC $\pm 10\%$ @ 5mA
Temperature Coefficient	100PPM/ $^\circ\text{C}$
Operating/Storage Temperature	-10° to $+60^\circ\text{C}/-20^\circ$ to $+70^\circ\text{C}$
Backlight Operating Range (for DC-AC)	4-6VDC @ 70mA
MTBF	80,000 Hours
Display	101 Segment Reflective LCD

CASE MATERIAL: U.L. approved ABS Polycarbonate 94VO rated. Black matte with acrylic anti-glare treated window.

ENVIRONMENTAL: NEMA 3 standard. NEMA 4 on request; gasket included and adjustment plugs sealed (not field scaleable).

ORDERING INFORMATION (1/1/97)

MODEL **5** **7** **5** - - - -

- INPUT RANGE (1,3)**
- 0 0+100 $^\circ\text{C}$
 - 1 0-100 $^\circ\text{F}$
 - 2 0+800 $^\circ\text{C}$
 - 3 0+1000 $^\circ\text{F}$

- POWER INPUT (2)**
- 0 5VDC
 - 1 120/240VAC
 - 2 120VAC
 - 3 7-32VDC

- CONNECTOR**
- 0 Flat Ribbon
 - 1 Screw Term.
- BACKLIGHT(4), CASE MTG.**
- 0 No Bklt, Vertical
 - 1 Backlight, Vertical
 - 4 No Bklt, Horizontal
 - 5 Backlight, Horizontal

NEMA 4 HOUSING ON REQUEST
Contact Otek

- (1) See scales section
- (2) 120/240 VAC is open frame P.S. Style; 120VAC is wall mount p.s.
- (3) ANSI ($\alpha=0.003923$) & 10 Ω Cu on request
- (4) Screw terminal connector must be ordered

575 MECHANICALS & TYPICAL CONNECTIONS

DESCRIPTION VERTICAL

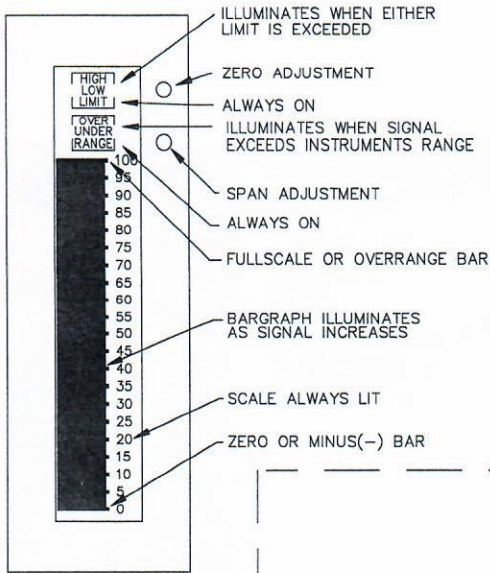

HORIZONTAL

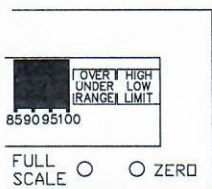

NOTE: HORIZONTAL 570 HAS THE SAME MECH. DIM. AS VERTICAL, EXCEPT THEY ARE ROTATED 90 DEGREES CLOCKWISE.

OPTIONAL SCREW TERMINAL CONNECTOR FRONT VIEW

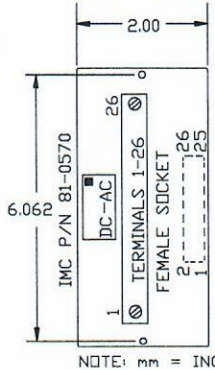

SIDE VIEW

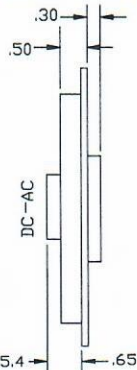

CONNECTOR END VIEW



STD. 26 PIN MALE FLAT RIBBON CONN.

PANEL CUT-OUT FRONT VIEW

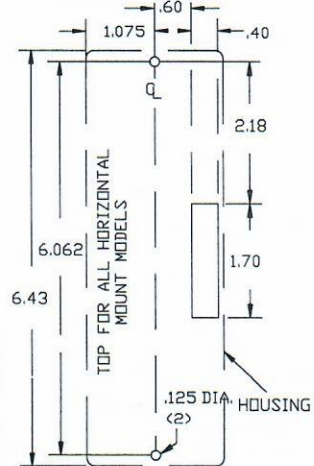

MECHANICALS

FRONT VIEW

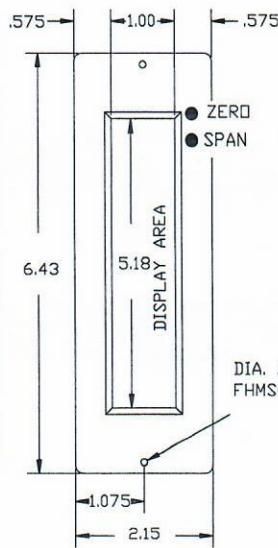

SIDE VIEW

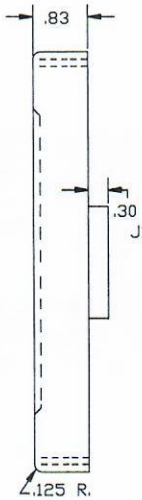

REAR VIEW

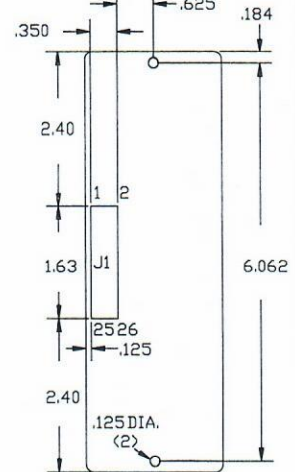

MOD. 575 RTD INPUT TYPICAL CONNECTIONS

POWER SUPPLY FOR BACKLIGHT

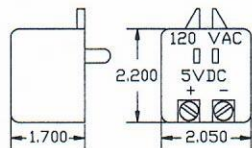

ORDER P/N 75-3110 FOR BACKLIGHT (5VDC)

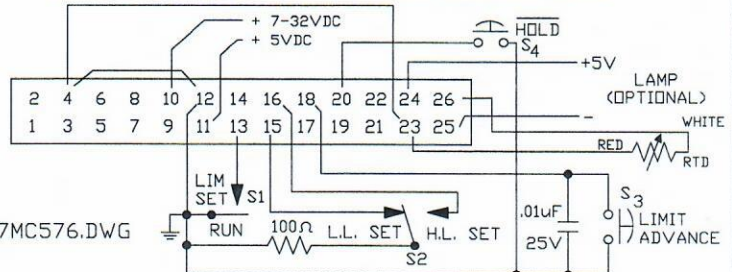

NOTES: (1) DO NOT CONNECT PINS NOT SHOWN CONNECTED. (2) S1 & S2 CAN BE COMBINED INTO ONE SWITCH HAVING CENTER OFF DPDT (ON-NONE-ON). SHOWN FOR 2 WIRE RTD. FOR 3 WIRE CONNECT EXTRA RED LEAD TO TERMINAL #4.

FAX: 520-790-2808
E-MAIL: otekcorp@primenet.com
Fax-Back#: 520-748-1539--0575

520-748-7900

OTЕК™
CORP.

SINCE 1974

4016 E. TENNESSEE ST.
TUCSON, AZ. 85714 U.S.A.

MADE
IN
USA

