

**NEW**

# POWERLESS™ High Reliability A.C. Signal Powered LCD Panel Meter

(Patent #'s 7,626,378; 4,908,569 & Pending)

**MODEL  
ACS-D**

**FEATURES:**

- 4 1/2 LCD Digits (.1.9.9.9.9) 1/2" High
- Plastic Housing 94-VO
- Captive Screw Terminal Connector
- Wide Zero & Span Adjustments
- NEMA 4X, EMI/RFI Gaskets (Optional)
- Replaces Velonex Meters
- Lifetime Warranty!

**Reflective**



Effective 12-14-11

**SPECIFICATIONS:**

- Burden: 100mW@120VAC
- Conversion Technique: RMS
- Accuracy & Linearity: +/- 0.1% of F.S. +/- 1 Digit
- Span Adjustment: +/- 3000 Counts of F.S. (10,000)
- Zero Adjustment: +/- 3000 Counts of Zero (00000)
- Standard Calibration: 0-F.S. = Per Range, Others On Request
- Operating Temp: -10+50 C
- Storage Temp: -20+70 C
- CMT BF.....>100 K Hours

**TYPICAL CONNECTIONS**

ACVH: TSV1  
 ACVL: TSV2  
 ACAH: TSA1  
 ACAL: TSA2

Model: ACS-D



Powered Model: LPM

**INPUT TYPE/RANGE**

\$175...V.....(30-150).....(P.T.) Volts  
 \$200...A.....(0.3-5).....(C.T.) Amps  
 \$175...H.....(40-440).....(P.T.) Frequency  
 \$250...W.....(Same as V & A).....(P.T & C.T.) Watts  
 CF...9.....Custom (Consult Factory)

**RANGE/CALIBRATION**

0.....STANDARD (see Text)...NC  
 9.....CUSTOM...CF

Ranges (Calibration): VAC: 30-150; AAC: 0.3-5, HZ: 40-440; WAC: 30-150VAC & 0.30-5 AAC (Decimal points are selectable)

**DESCRIPTION:** The ACS-D is a by-product of a model specifically designed for the Mil-Spec and Nuclear industries. OTEK makes it available to high demanding industrial customers for high reliability applications. Just connect the "hi" and "lo" signals and change the decimal points on display board (if required), and as a bonus, you get the "Peak & Hold" functions which allow you to capture transients or simply freeze the display (hold) for analytical purposes.

### MECHANICALS

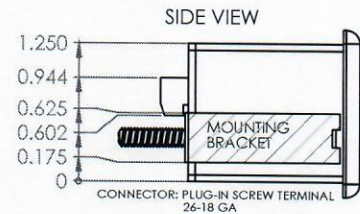
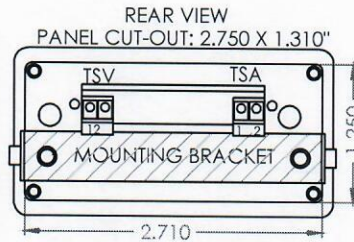
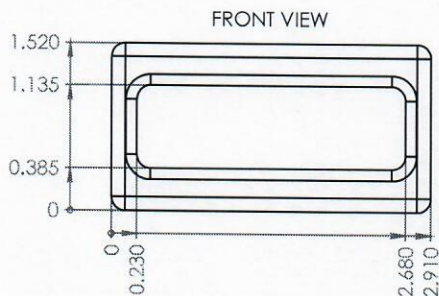

520-748-7900  
 FAX: 520-790-2808  
 E-MAIL:sales@otekcorp.com  
 http://www.otekcorp.com

**OTEK™** CORP.  
 SINCE 1974

4016 E. TENNESSEE ST.  
 TUCSON, AZ. 85714 U.S.A.

MADE  
 IN  
 USA

