

**NEW**

# POWERLESS™ Low Cost Explosion Proof A. C. Signal Powered LCD or LED Meter

**MODEL  
ACS-Z**

(Patent #'s 7,626,378; 4,908,569 & Pending)

**FEATURES:**

- 4 1/2 Reflective LCD or LED Display
- Hold and Peak & Hold
- Zero and Span Adjustments
- Lifetime Warranty!



**LED**

**SPECIFICATIONS:**

- Burden: 50mW@120VAC
- Conversion Technique: RMS
- Accuracy & Linearity: +/- 0.1% of F.S. +/- 1 Digit
- Zero & Span Adj.: +/- 3,000 Counts
- Meets Class I, Div. 1 & 2 Groups B-G
- ECex: Im2, Exd1
- Standard Calibration: 0-F.S.= Per Range
- Others on Request

**DESCRIPTION:** It cannot get any simpler: One ASIC, one display, and one P.C.B., the rest is innovative engineering to give you high reliability and long life expectancy (>100 K Hours). You can select the decimal point position (on the display board) or tell us when ordering and use the included "Hold" and "Peak & Hold" to analyze transients. Why pay twice as much when the ACS-Z would do better?

**Powered Model: LPX**

Effective 6-18-12

Model: ACS-Z

**INPUT TYPE/RANGE**

(V)	\$395	.....V.....(30-150).....	Volts
(A)	\$445	.....A.....(0.3-5).....	Amps
(W)	\$495	.....H.....(40-440).....	Frequency
(H)	\$395	.....W.....(Same as V & A).....	Watts
CF	.....9.....	.....Custom (Consult Factory).....	



**LCD-  
On  
Request**

Ranges (Calibration): VAC: 30-150; AAC: 0.3-5; HZ: 40-440; WAC: 30-150VAC & 0.30-5 AAC (Decimal points are selectable)

**Note:** Display is calibrated as per range stated unless otherwise specified (Digit 2, Option 9).

**For I.R. Programmable Version-See Model LPX**

## MECHANICAL AND TYPICAL CONNECTIONS

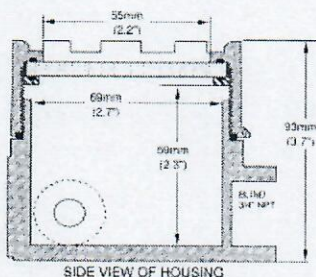
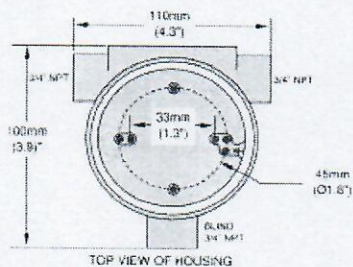

**FIG.  
LPX-DP**

**DECIMAL POINT SELECT**

- 1: CAL: ADJUST ZERO BEFORE SPAN
- 2: DP SELECT

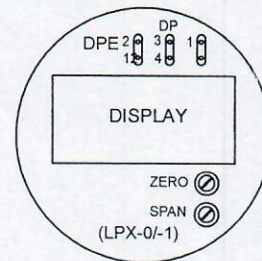

- NONE: DPE1 TO 2
- 1.XXX: NO JUMP + DPE
- 1X.XXX: DP3 TO 4 + DPE
- 1XX.XX: DP1 TO 2 + DPE
- 1XXX.X: DPE1 TO 2 & 3 TO 4 +DPE

**NOTE:** FOR NO D.P. REMOVE DPE JUMPER

**NOTE:** Do not remove cover in hazardous area, remove cover and select decimal point desired in safe area.

**520-748-7900**  
 FAX: 520-790-2808  
 E-MAIL: sales@otekcorp.com  
 http://www.otekcorp.com



4016 E. TENNESSEE ST.  
 TUCSON, AZ. 85714 U.S.A.

MADE  
 IN  
 USA

